

# Scupper

**Attention:** The processing instructions of the roofing membrane manufacturers must be observed; Materials and material compounds used may be subject to changes

**Function:**

Moulded part for horizontal drainage through the parapet. Can be installed with a connection to a pipe system for water drainage or free discharge. When installing for emergency drainage, the exact installation point must be chosen depending on the water height.

**Material:**

Variants PVC, FPO/PP<sup>2</sup> and BIT for connection to the respective matching material variant of the roofing membrane. The materials are modified to be weather-resistant: UV-stabilised against heat degradation and oxidative ageing as well as cold impact resistant.

**Available sizes:**

- D 50 mm (DN 50)
- D 63 mm
- D 75 mm (DN 70)
- D 90 mm
- D 110 mm (DN 100)
- D 125 mm (DN 125)<sup>3</sup>

**Packaging units:**

Delivery in box, PU 1 piece

**Accessories<sup>4</sup>:**

- Gravel guard
- Vapour barrier sheet

**Drainage capacity:**

LGA-certified performance data

Diameter	Attenuation depth	
	35 mm	65 mm
D 50 mm (DN 50)	0.51 l/s	1.31 l/s
D 63 mm	n/a	n/a
D 75 mm (DN 70)	0.65 l/s	1.65 l/s
D 90 mm	0.65 l/s	1.90 l/s
D 110 mm (DN 100)	1.00 l/s	2.65 l/s
D 125 mm (DN 125) <sup>3</sup>	1.00 l/s	2.80 l/s

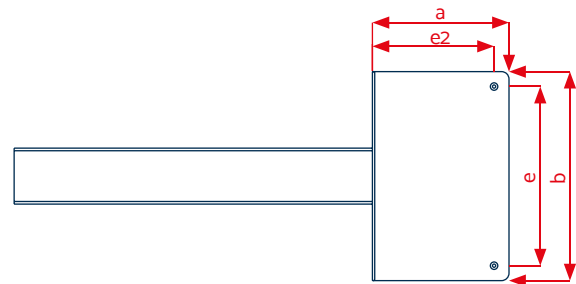
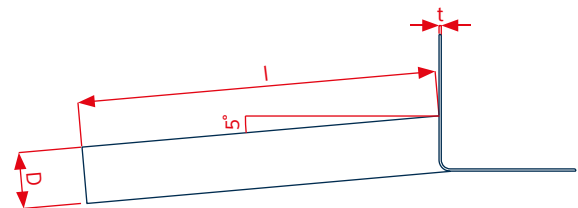
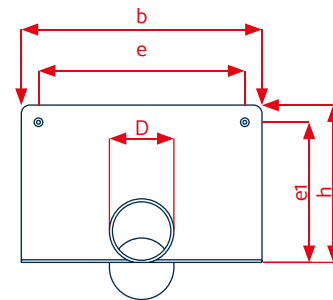

Technical data			
D	50 / 63 / 75 / 90 / 110 / 125 mm <sup>3</sup>		
l	480 mm <sup>1</sup>	e	240 mm
a	112 mm	e1	166 mm
b	280 mm	e2	92 mm
h	186 mm	t	3 mm
Pipe inclination 5°			

<sup>1</sup>Special lengths available on request / <sup>2</sup>Also available in PE (roofing membranes based on PE) / <sup>3</sup>**Attention:** Please note that technical dimensions and visual representations may differ from the illustration / <sup>4</sup> Also available with accumulation ring  
 KALA - KUNSTSTOFFE | Karl-Heinz Lange GmbH+Co.KG reserves the right to make technical changes.