

Emergency overflow, round

Function:

Moulded part for horizontal emergency drainage through the parapet wall. Install by connecting to a pipe system for water drainage, or use for free-flow drainage. When installing the emergency overflow, the precise installation point depends on the water level.

Material:

Our emergency overflows are available in PVC, FPO/PP² and BIT for connection to the matching material used for the roof membrane. The materials are modified to be weather-resistant: UV-stabilised, against heat degradation and oxidative ageing as well as resistant to cold impact.

Available sizes:

- D 50 mm (DN 50)
- D 63 mm
- D 75 mm (DN 70)
- D 110 mm (DN 100)
- D 125 mm (DN 125)

Package units:

Supplied in cartons, PU 1 unit

Accessories:

Vapour barrier sheet for round and rectangular scuppers and emergency overflows

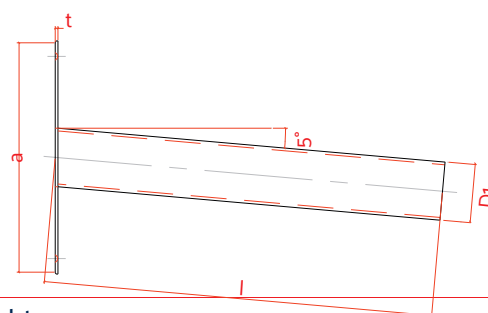
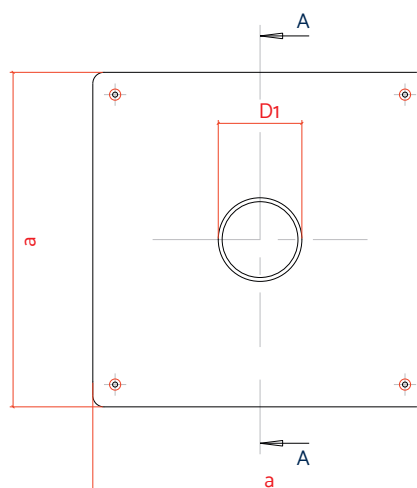

Drainage performance litre/sec.:

LGA-certified characteristics

Technical data		
Diameter	Accumulation height	
	35 mm	65 mm
D 50 mm (DN 50)	0.51	1.31
D 75 mm (DN 70)	0.65	1.65
D 110 mm (DN 100)	1.00	2.65
D 125 mm (DN 125)	1.00	2.80

Technical data		
D1	50 / 63 / 75 / 110 / 125	mm
a	300	
l	490 ¹	
t	3.0	
Pipe inclination 5°		

¹Special sizes available on request / ²Also available in PE (roofing membranes based on PE). The processing instructions of the roof sheeting manufacturer must be observed; Materials and material compounds used may be subject to change. KALA – KUNSTSTOFFE | Karl-Heinz Lange GmbH+Co.KG reserves the right to make technical changes.